

# Polar Partitioning



Free no obligation survey  
and quotation service  
Call: **0800 975 4933**

**AVANTA**  
WORKSPACE CREATION

# POLAR Partitioning



## Contents

Polar Single Glazed	04
Polar Double Glazed	18
Polar Vision	32
PolarTec	46
Polar 100	56
Confluence	64
Polar SG featuring Workwall	72
Glass Doors	80
Blinds & Graphics	90
Integral Blinds	92
Graphics	93
Manifestation	94
SwitchGlass	96
The Kompendium	98
Services	102
Partitioning Performance Comparison Chart	Inside Back Cover



Full height faceted single glazed Polar incorporating single glazed doors within standard height SJ35 doorframes and glazed overpanel

# POLAR Single Glazed

Polar partitioning product comparison chart can be found on the inside back cover of this brochure

clarity



Full height single glazed Polar incorporating  
pivot single glazed doors with patch fixings  
and glazed overpanel

POLAR  
Single Glazed





Full height heat soak treated  
single glazed Polar to the edge  
of the mezzanine floor

POLAR  
Single Glazed





POLAR  
Single Glazed

Full height single  
glazed Polar  
with full height  
double timber  
doors and frames







Angled single glazed  
Polar to ground floor  
and mezzanine

# POLAR Single Glazed

Polar single glazed is a frameless dry or silicon vertical jointed system

## Technical spec at a glance

 **DIMENSIONS:**  
Up to 3300mm high

 **FIRE RATINGS:**  
Up to 30/30

 **ACOUSTICS:**  
Up to 38dB (Rw)

 **STRUCTURE:**  
Up to severe duty

 **DEFLECTION HEAD (+/-):**  
YES

 **WEIGHT Per m<sup>2</sup> (kg):**  
Up to 37.53

 **BLINDS:**  
N/A

 **MANIFESTATION:**  
Yes

Detailed Polar Single Glazed drawings can be found on pages 16-17. In addition a partitioning product comparison chart can be found on the inside back cover of this brochure.

For further technical specifications and technical drawing downloads go to - [www.komfort.com](http://www.komfort.com)



Curved single glazed  
Polar with banded  
manifestation

Available in straight striking lines, facets, or the  
most graceful curves, Polar's minimalist form exudes  
elegance and luxury in all kinds of surroundings.

## POLAR Single Glazed



Full height single glazed Polar



Faceted single glazed Polar  
incorporating standard height  
Manet sliding glass door



Full height curved single glazed Polar  
incorporating bespoke manifestation



# POLAR Single Glazed

## Isometric and Junction Details

### Polar Single Glazed partitioning system

- 01 Head /abutment channel
- 02 Abutment seal
- 03 PVCu glazing channel
- 04 Straight jointing cleat
- 05 90° jointing cleat
- 06 Aluminium door frame flat profile
- 07 Door frame seal
- 08 10/12mm toughened safety glass
- 09 10mm/12mm toughened safety glass door
- 10 Base channel
- 11 Base channel leg
- 12 Glazing bead
- 13 Glass packer
- 14 Door frame glazing channel

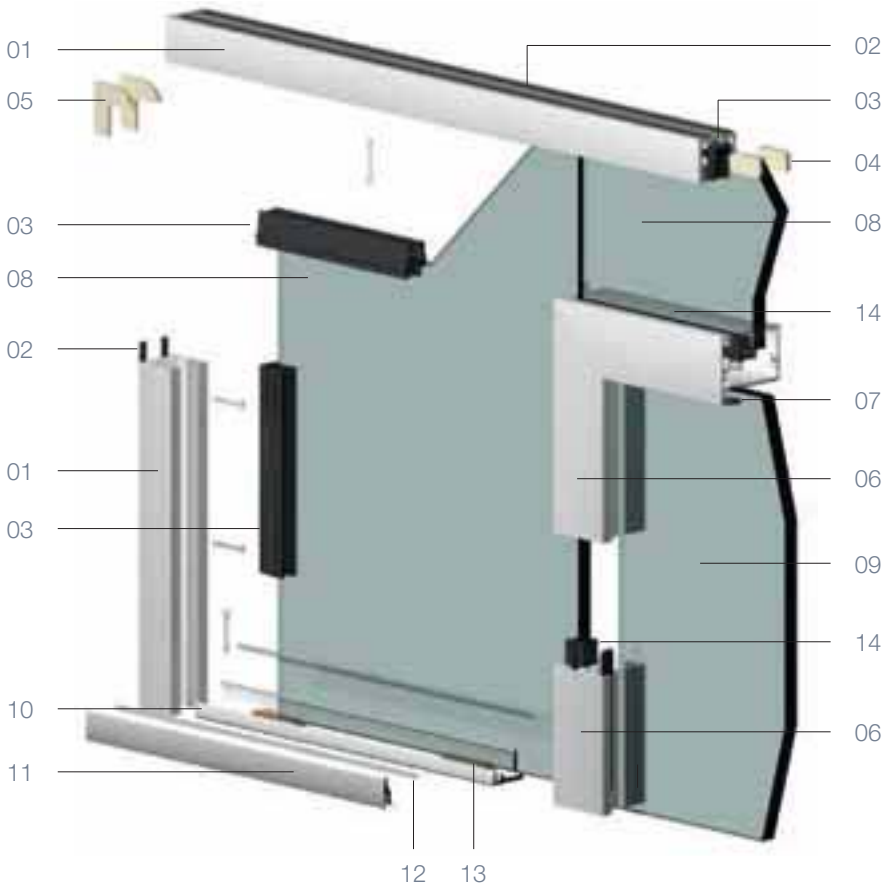

### Polar Single Glazed partitioning system

- 01 Head /abutment channel
- 02 Abutment seal
- 03 PVCu glazing channel
- 04 Straight jointing cleat
- 05 90° jointing cleat
- 06 Aluminium door frame round profile
- 07 Door frame seal
- 08 10/12mm toughened safety glass
- 09 10mm/12mm toughened safety glass door
- 10 Base channel
- 11 Base channel leg
- 12 Glazing bead
- 13 Glass packer
- 14 Door frame glazing channel

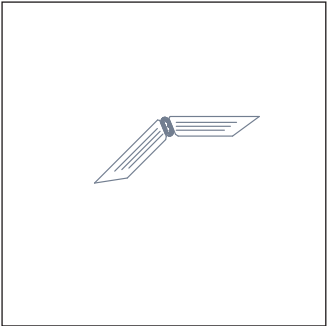
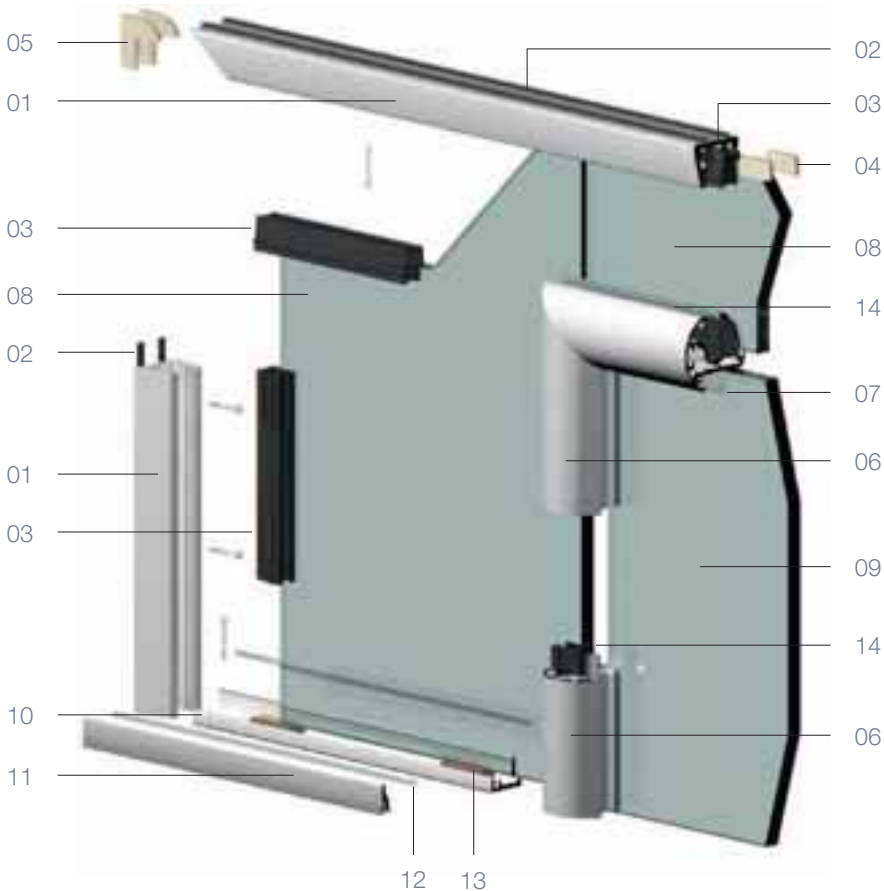

135° glazed junction

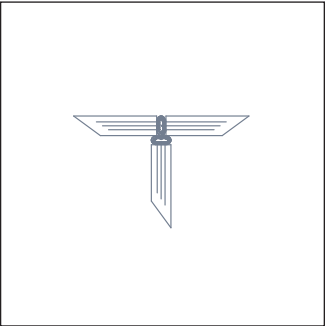

3 way glazed junction

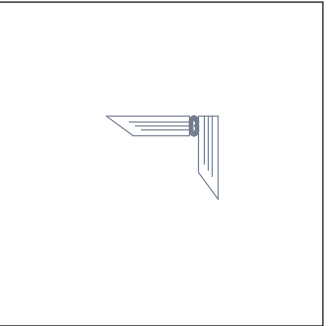

90° glazed junction

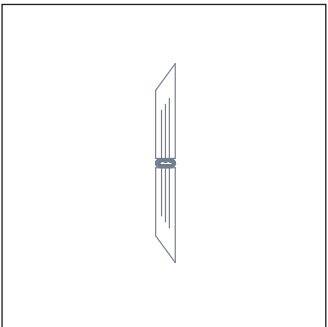

Glazed to glazed junction

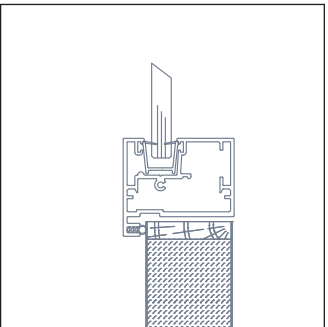

Glazed to aluminium door frame with timber door

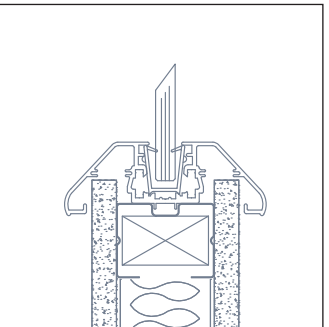

Reducer post from 75mm plasterboard partition system

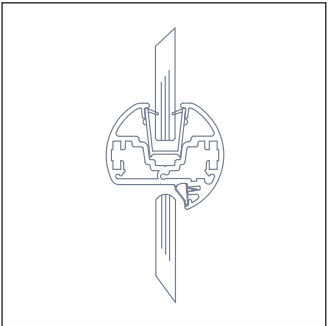

Glazed to halo auminium door frame with glass door

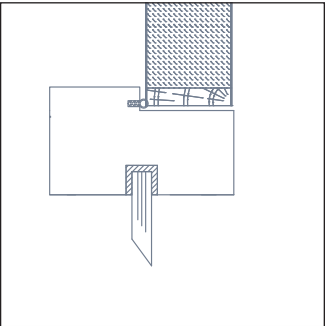

Glazed to timber door frame with timber door

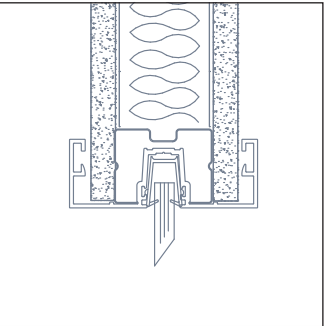

Glazing pocket from 75mm plasterboard partition system

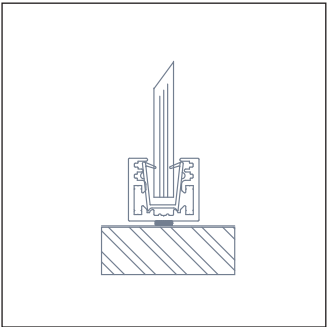

Glazed abutment

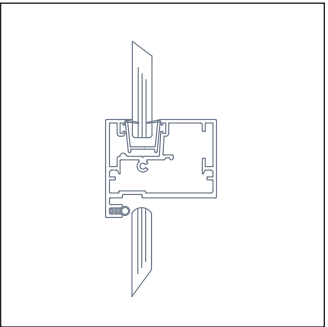

Glazed to aluminium door frame with glass door

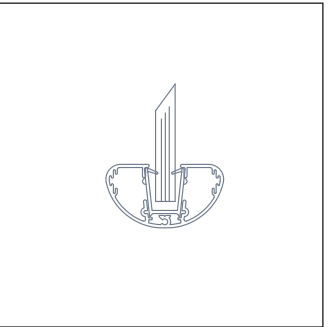

Glazed fair end

These drawings are for guidance only. For comprehensive information please contact our technical department



Double glazed Polar with full height DGP25  
doorframe and veneered door

# POLAR Double Glazed



Polar partitioning product comparison chart can be  
found on the inside back cover of this brochure

chic



Full height double glazed Polar  
incorporating single glazed doors  
within full height Halo doorframes

POLAR  
Double Glazed





Full height double  
glazed Polar with  
full height flush  
double glazed door

POLAR  
Double Glazed

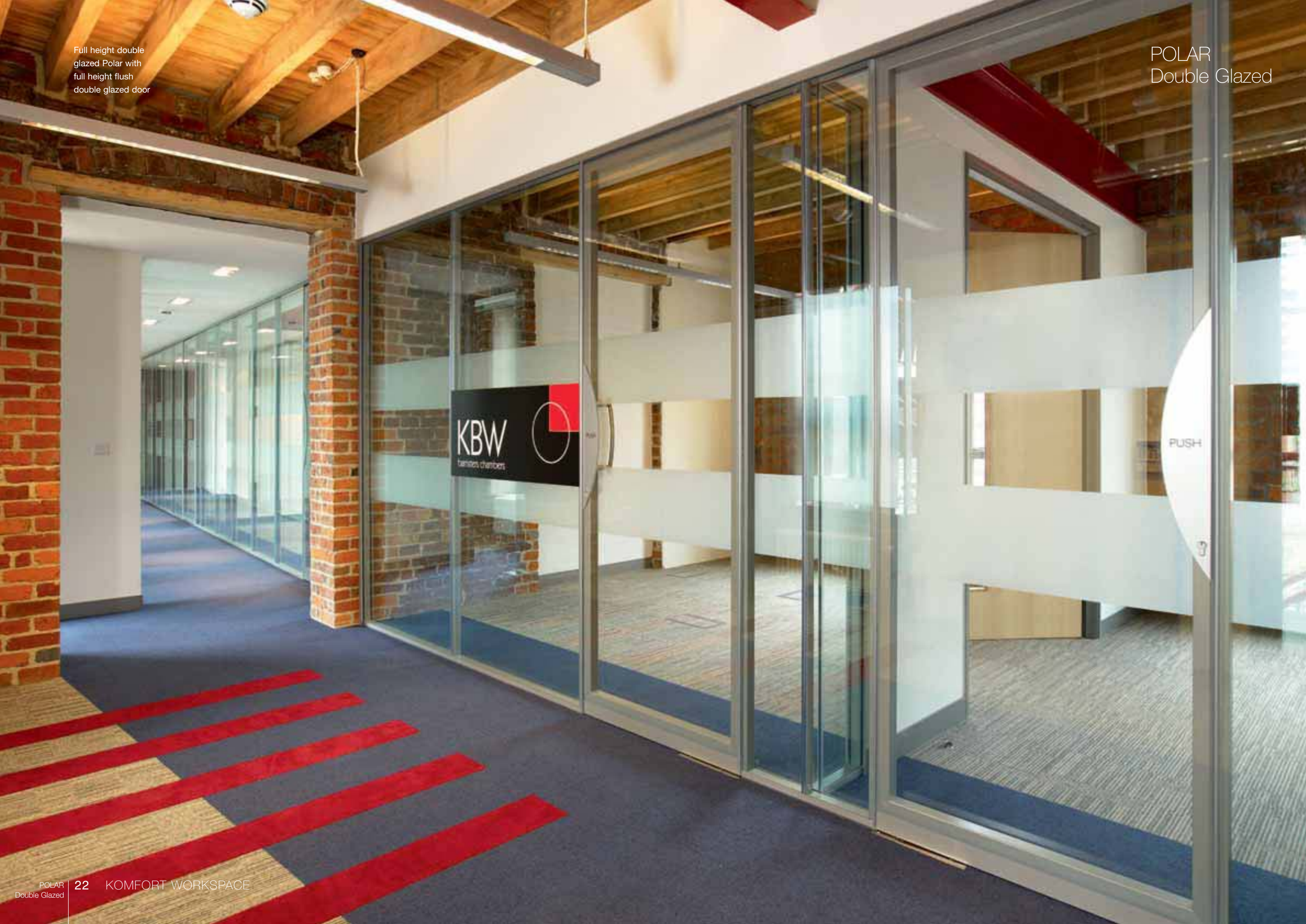



Full height double glazed Polar with integral blinds featuring standard height timber doors and rebated overpanel within full height Halo doorframes

POLAR  
Double Glazed





Full height faceted double glazed Polar

POLAR  
Double Glazed

Polar double glazed is a frameless dry vertical jointed system with ghost post mullions

Technical spec at a glance	
	DIMENSIONS: Up to 3300mm high
	FIRE RATINGS: N/A
	ACOUSTICS: Up to 49dB (Rw)
	STRUCTURE: Up to severe duty
	DEFLECTION HEAD (+/-): YES
	WEIGHT Per m <sup>2</sup> (kg): Up to 60.36
	BLINDS: Yes - integral
	MANIFESTATION: Yes

Detailed Polar Double Glazed drawings can be found on pages 30-31. In addition a partitioning product comparison chart can be found on the inside back cover of this brochure.

For further technical specifications and technical drawing downloads go to - [www.komfort.com](http://www.komfort.com)



Full height double glazed Polar incorporating full height DGP25 doorframe containing veneered door and rebated overpanel. To the left of the door is Polar Vision with Polar single glazed at the end of the run

The discreet mullions and framework of double glazed Polar combine contemporary aesthetics, elegance and durability. A tried and tested system that creates a stunning look in any working environment.

## POLAR Double Glazed



Full height double glazed Polar with bespoke manifestation



Full height double glazed Polar with standard height halo doorframe, double glazed overpanel and glass door



Full height double glazed Polar with banded manifestation



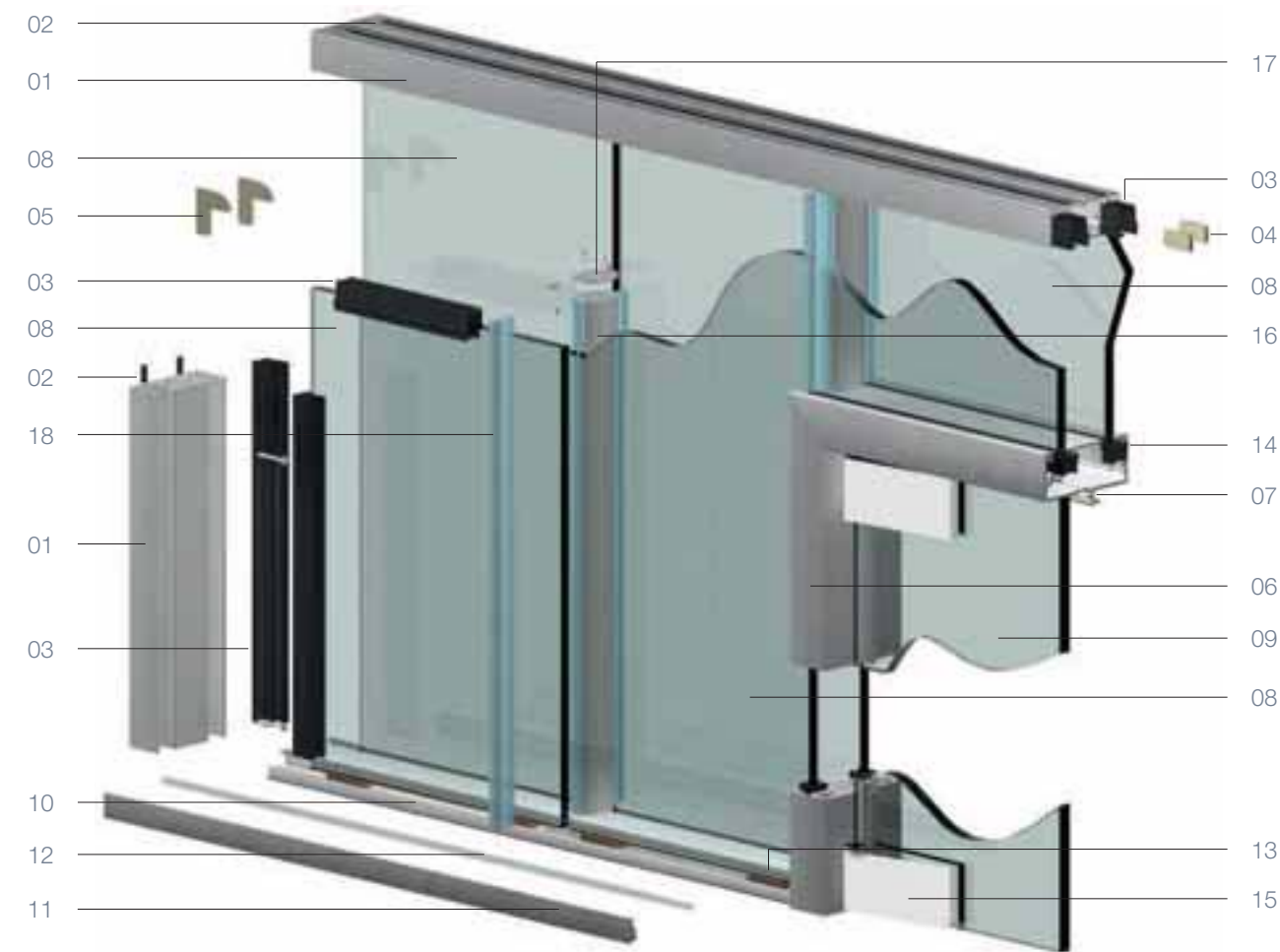

Polar Double Glazed - partitioning system

- |                                   |   |                              |
|-----------------------------------|---|------------------------------|
| 01 Head /abutment channel         | 09 10mm /12mm toughened safety glass door | 16 Ghost post                |
| 02 Abutment seal                  | 10 Base channel                           | 17 Ghost post securing plate |
| 03 PVCu glazing channel           | 11 Base channel leg                       | 18 Glass securing nail       |
| 04 Straight jointing cleat        | 12 Glazing bead                           |                              |
| 05 90° jointing cleat             | 13 Glass packer                           |                              |
| 06 Aluminium door frame           | 14 Door frame glazing channel             |                              |
| 07 Door frame seal                | 15 Pivot patch fitting                    |                              |
| 08 10/12mm toughened safety glass |   |                              |

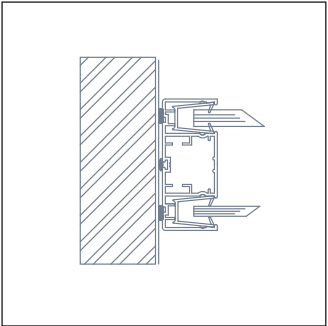

Glazed abutment

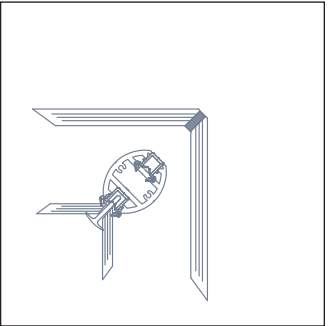

90° glazed junction

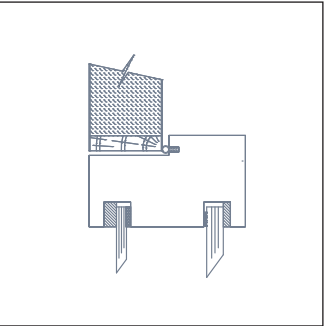

Glazed to timber door frame with timber door

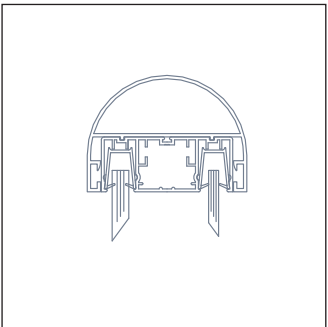

Glazed fair end

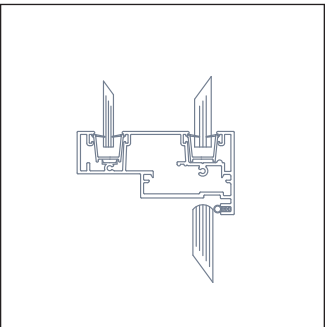

Glazed to aluminium door frame with flush door stop and glass door

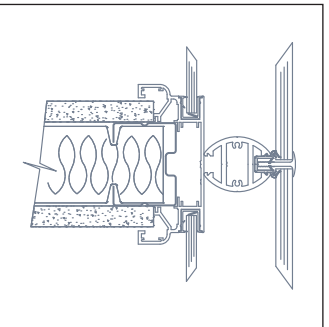

3 way glazed to solid to glazed junction

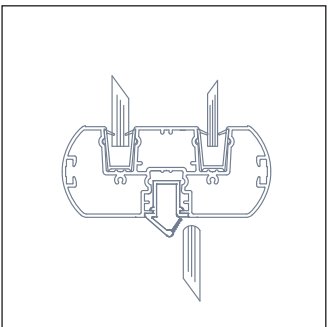

Glazed to halo aluminium door frame with glass door

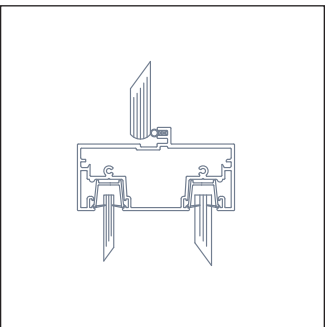

Glazed to aluminium door frame with central door stop and glass door

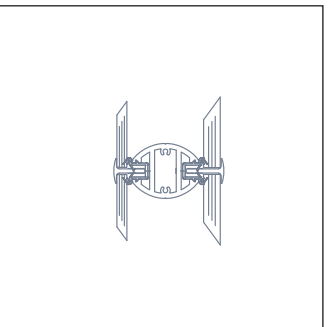

Glazed to glazed junction

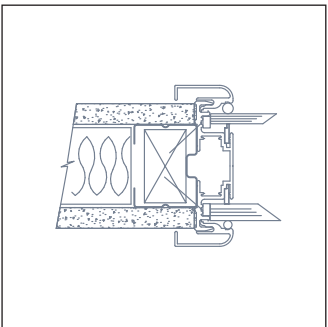

Glazing to 75mm plasterboard partition system

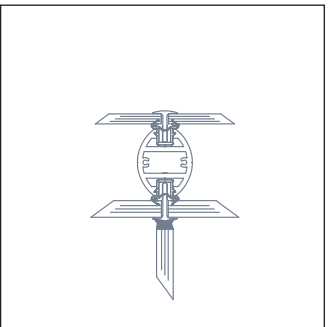

3 way double glazed to single glazed

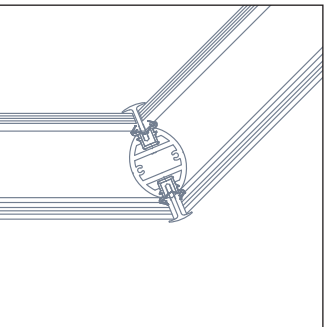

135° glazed junction

These drawings are for guidance only. For comprehensive information please contact our technical department

Polar partitioning product comparison chart can be found on the inside back cover of this brochure



Faceted Polar Vision with full height applied graphics

# POLAR Vision



Polar partitioning product comparison chart can be found on the inside back cover of this brochure

# intrigue







Full height Polar Vision with striking  
bespoke manifestation

POLAR Vision











Full height Polar Vision incorporating timber panels

# POLAR Vision

Polar Vision is a frameless dry vertical jointed system

Technical spec at a glance

 **DIMENSIONS:**  
Up to 3000mm high

 **FIRE RATINGS:**  
Up to 30/30

 **ACOUSTICS:**  
Up to 48dB (Rw)

 **STRUCTURE:**  
Up to heavy duty

 **DEFLECTION HEAD (+/-):**  
YES

 **WEIGHT Per m<sup>2</sup> (kg):**  
Up to 55.36

 **BLINDS:**  
N/A

 **MANIFESTATION:**  
Yes

Detailed Polar Vision drawings can be found on pages 44-45. In addition a partitioning product comparison chart can be found on the inside back cover of this brochure.

For further technical specifications and technical drawing downloads go to - [www.komfort.com](http://www.komfort.com)



Full height Polar Vision creating a meeting area



Inspiration and innovation reach new heights with Polar Vision. Its minimal form, confident lines and unrestricted views deliver opulence and exclusivity in any office.

## POLAR Vision



Full height Polar Vision with full height Halo double doorframe incorporating glass doors with patch hinges



Faceted and straight Polar Vision with full height timber doorframe incorporating standard height veneered door and rebated overpanel



Polar Vision with full height flush double glazed doors with Part M compliant dot manifestation



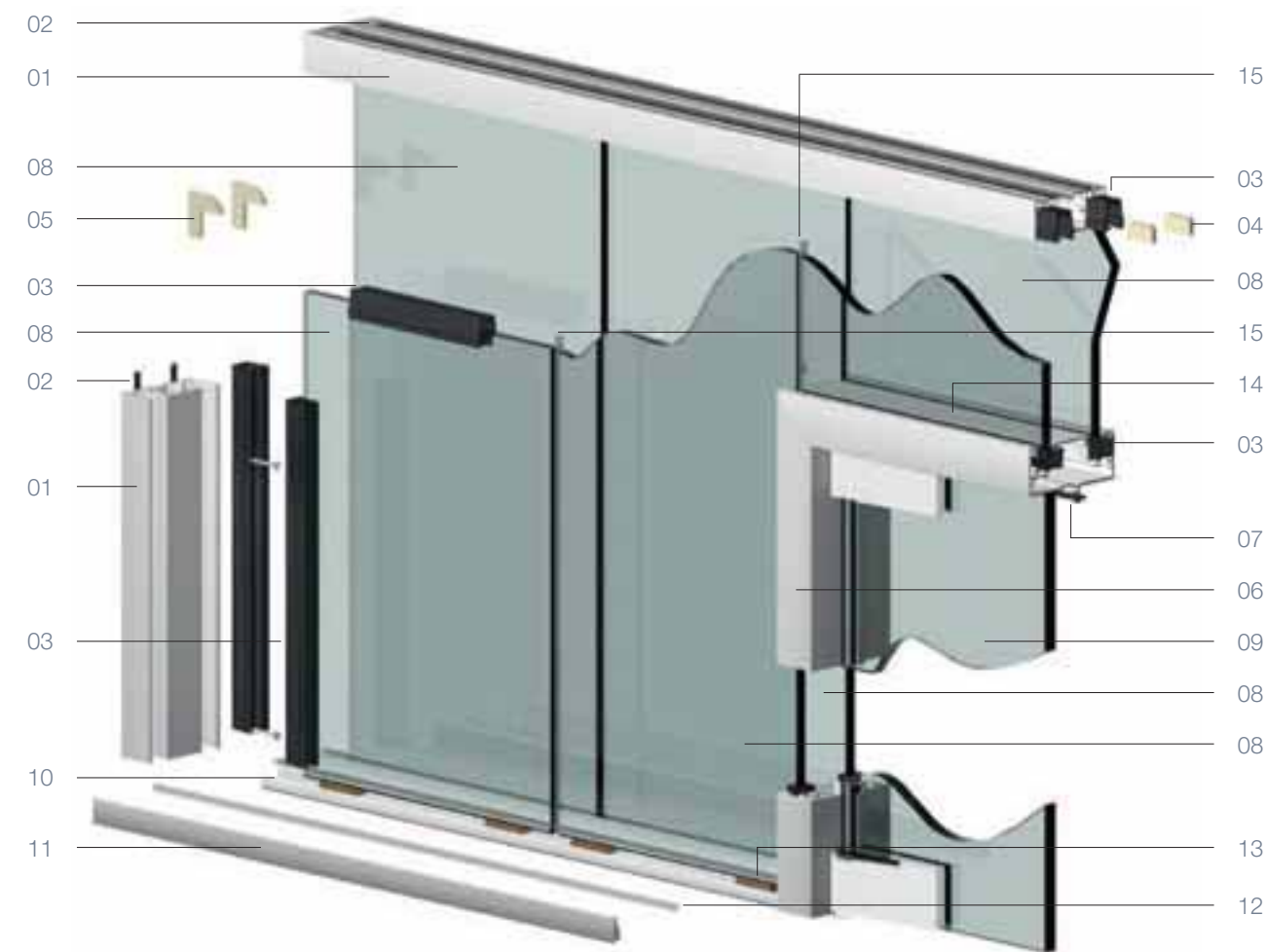

Polar Vision - double glazed partitioning system

- |                            |  |  |
|----------------------------|--|--|
| 01 Head /abutment channel  | 08 10/12mm toughened safety glass      | 13 Glass packer                            |
| 02 Abutment seal           | 09 10/12mm toughened safety glass door | 14 Door frame glazing channel              |
| 03 PVCu glazing channel    | 10 Base channel                        | 15 Self adhesive translucent glazing joint |
| 04 Straight jointing cleat | 11 Base channel leg                    |  |
| 05 90° jointing cleat      | 12 Glazing bead                        |  |
| 06 Aluminium door frame    |  |  |
| 07 Door frame seal         |  |  |

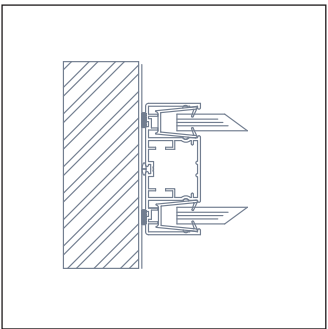

Glazed abutment

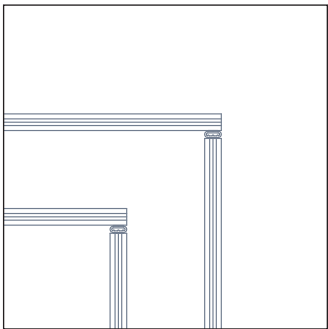

90° glazed junction

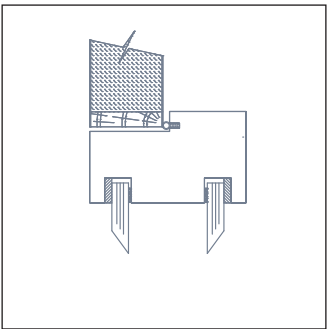

Glazed to timber door frame with timber door

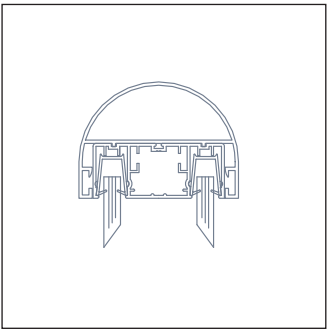

Glazed fair end

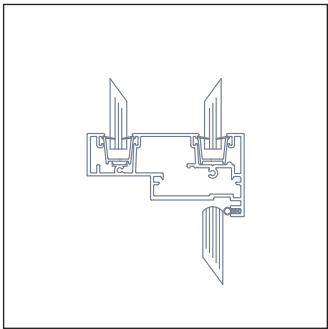

Glazed to aluminium door frame with flush door stop and glass door

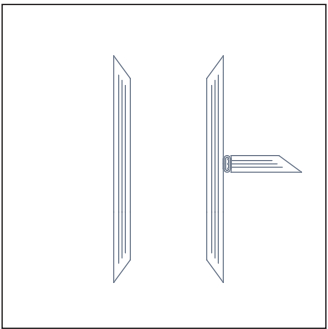

3 way double glazed to single glazed junction

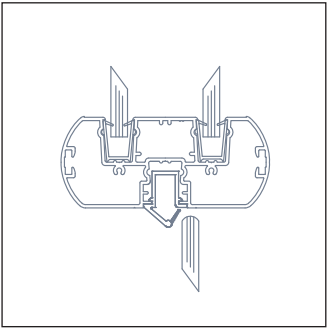

Glazed to halo aluminium door frame with glass door

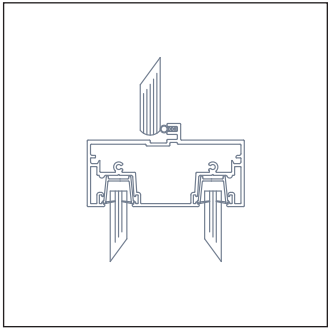

Glazed to aluminium door frame with central door stop and glass door

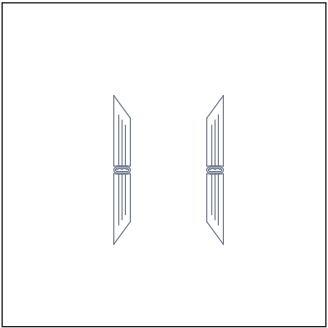

Glazed to glazed junction

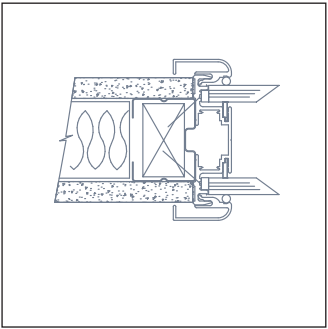

Glazing to 75mm plasterboard partition system

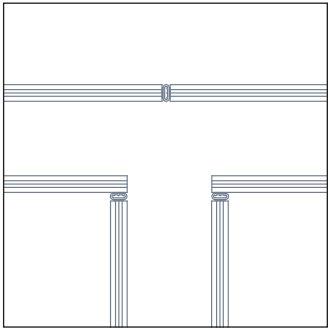

3 way double glazed junction

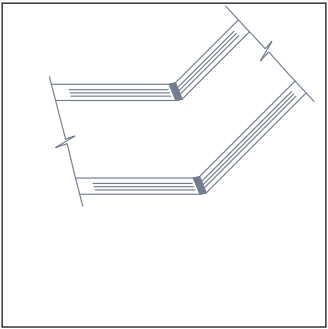

135° glazed junction

These drawings are for guidance only. For comprehensive information please contact our technical department

Polar partitioning product comparison chart can be found on the inside back cover of this brochure



Full height faceted PolarTec with applied graphics



# POLAR Tec

Polar partitioning product comparison chart can be found on the inside back cover of this brochure

# robust



Full height PolarTec  
with applied film  
signage

POLAR Tec



Faceted PolarTec  
with full height  
applied graphics

Communications

POLAR Tec

PolarTec is a frameless dry vertical jointed system with deflection head

Technical spec at a glance

 **DIMENSIONS:**  
Up to 3000mm high

 **FIRE RATINGS:**  
Up to 30/30

 **ACOUSTICS:**  
Up to 48dB (Rw)

 **STRUCTURE:**  
Up to heavy duty

 **DEFLECTION HEAD (+/-):**  
YES

 **WEIGHT Per m<sup>2</sup> (kg):**  
Up to 55.36

 **BLINDS:**  
N/A

 **MANIFESTATION:**  
Yes

Detailed PolarTec drawings can be found on pages 54-55. In addition a partitioning product comparison chart can be found on the inside back cover of this brochure.

For further technical specifications and technical drawing downloads go to - [www.komfort.com](http://www.komfort.com)





Displaying the breathtaking appearance of its contemporaries, PolarTec provides the added security of outstanding performance for those exceptionally demanding applications.

POLAR Tec



Full height PolarTec



Full height faceted PolarTec with applied graphics



Full height PolarTec with dotted applied manifestation



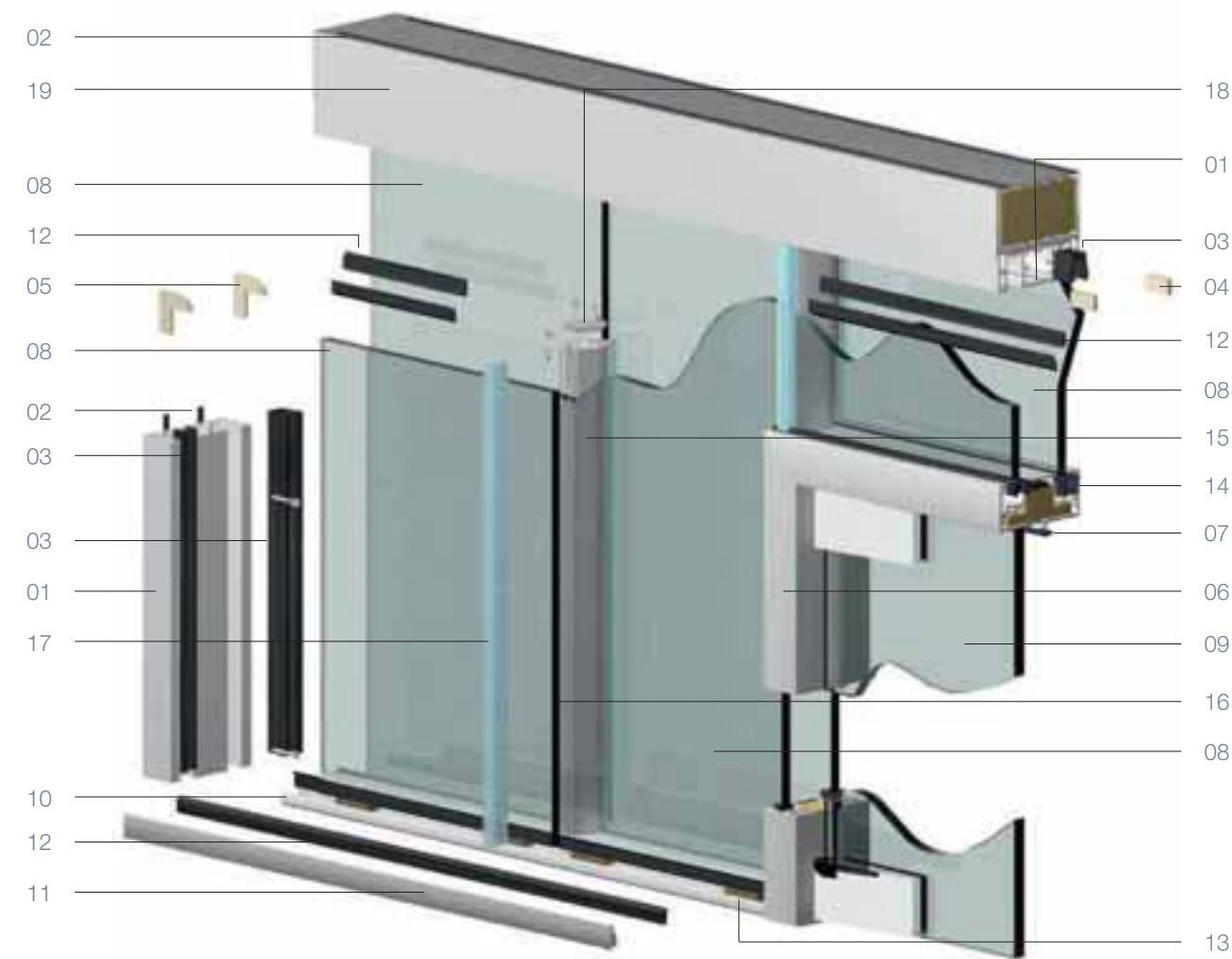

**PolarTec** - double glazed partitioning system

- |                            |  |                                  |
|----------------------------|--|----------------------------------|
| 01 Head /abutment channel  | 08 10/12mm toughened safety glass      | 13 Glass packer                  |
| 02 Abutment seal           | 09 10/12mm toughened safety glass door | 14 Door frame glazing channel    |
| 03 PVCu glazing channel    | 10 Base channel                        | 15 Ghost post                    |
| 04 Straight jointing cleat | 11 Base channel leg                    | 16 Plastic glazing joint pocket  |
| 05 90° jointing cleat      | 12 Glazing bead                        | 17 Plastic glazing joint nail    |
| 06 Aluminium door frame    |  | 18 Ghost post fixing plate       |
| 07 Door frame seal         |  | 19 Outer deflection head channel |

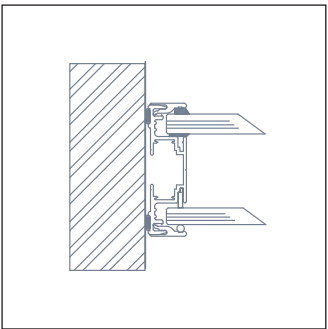

Glazed breakdown abutment

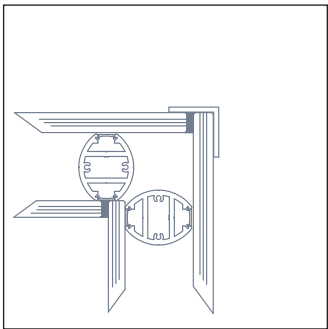

90° external glazed junction

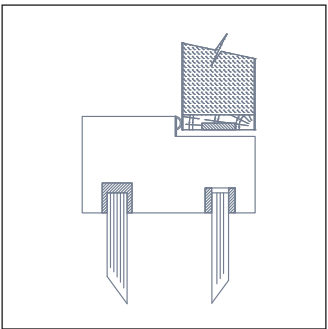

Glazed to timber door frame with timber door

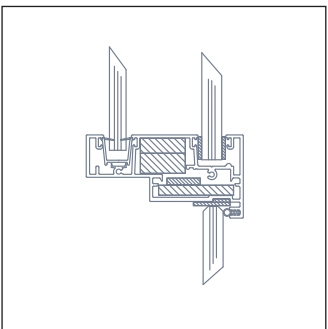

Glazed to aluminium door frame with flush door stop and glass door

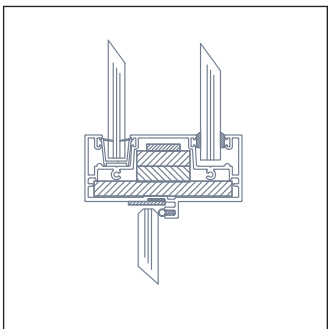

Glazed to aluminium door frame with central door stop and glass door

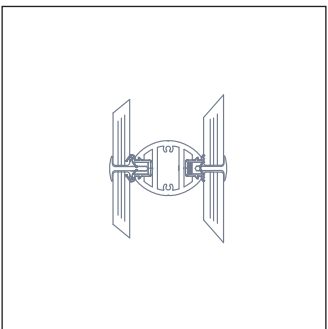

Glazed to glazed junction

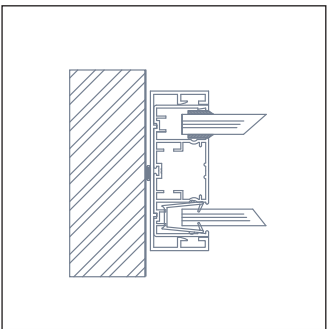

Glazing abutment

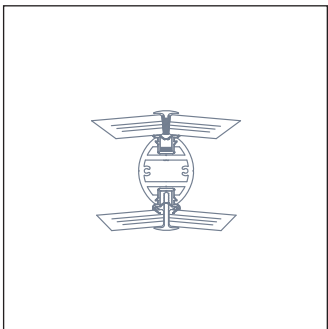

10° faceted glazed junction

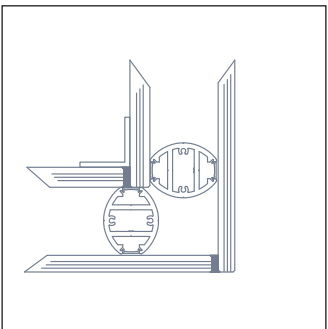

90° internal glazed junction



Full height Polar 100 incorporating glazing with solid elements and full height PSQ4 Polar 100 doorframe containing a full height door with vision panels

# POLAR 100

Polar partitioning product comparison chart can be found on the inside back cover of this brochure



sleek











Full height Polar 100  
solid panels integrating  
with double glazed Polar

# POLAR 100

Polar 100 is a seamless (taped and filled or skimmed) solid partition and frameless glazed dry or silicon vertical jointed system

## Technical spec at a glance

	<b>DIMENSIONS:</b> Up to 3000mm high
	<b>FIRE RATINGS:</b> Contact our technical department
	<b>ACOUSTICS:</b> Solid - up to 50dB (Rw) Double Glazed - up to 48dB (Rw)
	<b>STRUCTURE:</b> Up to severe duty
	<b>DEFLECTION HEAD (+/-):</b> YES
	<b>WEIGHT Per m<sup>2</sup> (kg):</b> Solid up to 46.08 Glazed up to 53.85
	<b>BLINDS:</b> Yes - integral
	<b>MANIFESTATION:</b> Yes

Detailed Polar 100 drawings can be found on pages 62-63. In addition a partitioning product comparison chart can be found on the inside back cover of this brochure.

For further technical specifications and technical drawing downloads go to - [www.komfort.com](http://www.komfort.com)



Full height double glazed Polar 100  
with dado height solid sections and  
PSQ4 doorframe



Ingenious and versatile, this sought after system  
combines single glazed, double glazed and solid  
elements to accommodate full integration and  
produce a streamlined effect.

## POLAR 100



Polar 100 PSQ4 doorframe  
containing glass door



Full height Polar 100 partitioning  
with solid and glazed elements



Single glazed Polar partitioning  
incorporating Polar 100 PSQ4  
doorframes and glass doors



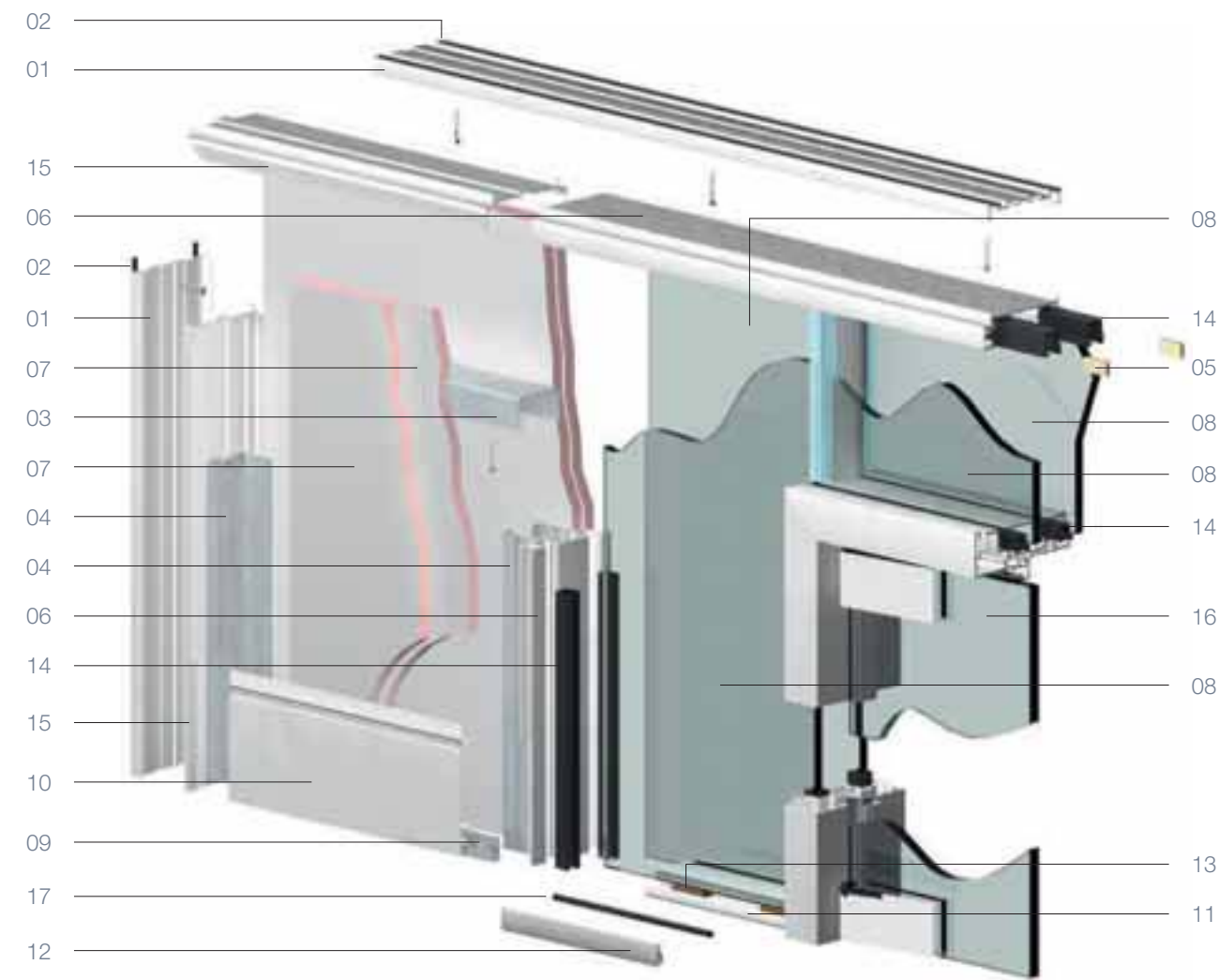

**Polar 100** - double glazed partitioning system designed to integrate with solid sections

- |                            |                                   |  |
|----------------------------|-----------------------------------|--|
| 01 Head / abutment channel | 08 10/12mm toughened safety glass | 14 PVCu glazing channel                |
| 02 Head channel seal       | 09 Skirting clip                  | 15 Plaster edge channel                |
| 03 Steel head / base track | 10 100mm skirting                 | 16 10/12mm toughened safety glass door |
| 04 Steel vertical stud     | 11 Base channel                   | 17 Glazing bead                        |
| 05 Straight jointing cleat | 12 Base channel leg               |  |
| 06 Glazing channel         | 13 Glass packer                   |  |
| 07 12.5mm plasterboard     |                                   |  |

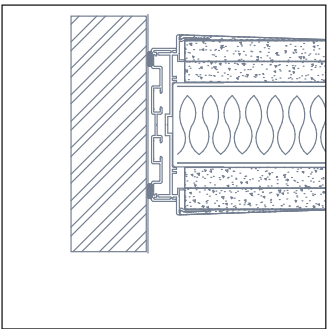

Solid abutment

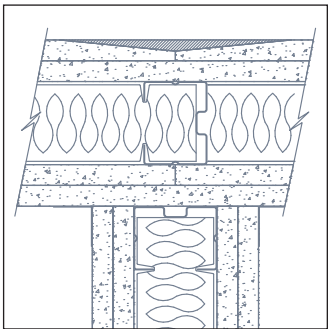

3 way solid junction

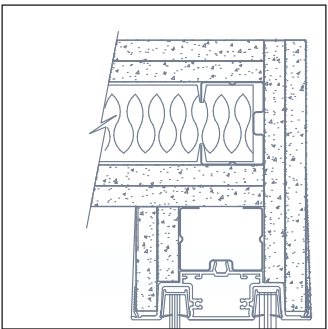

90° solid to glazed junction

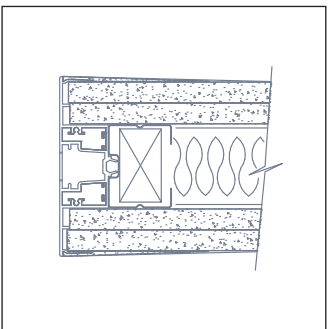

Solid fair end

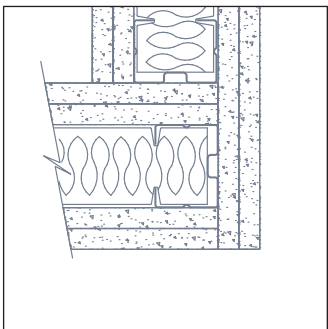

90° solid to solid junction

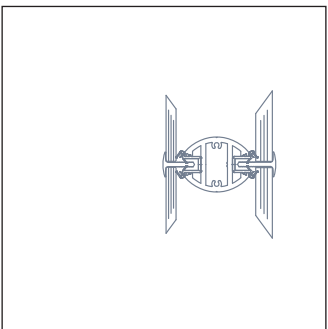

Glazed to glazed junction

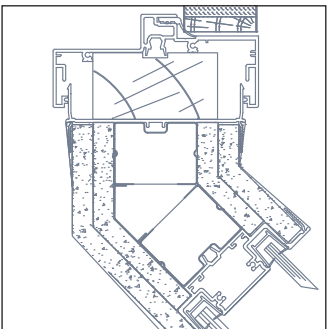

135° glazed to doorset junction

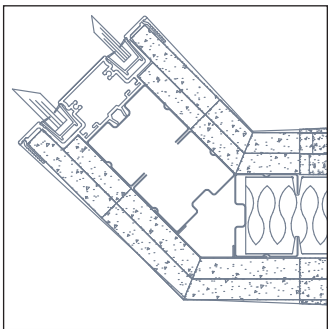

135° solid to glazed junction

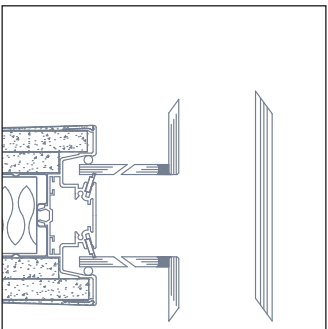

3 way glazed to solid to glazed junction

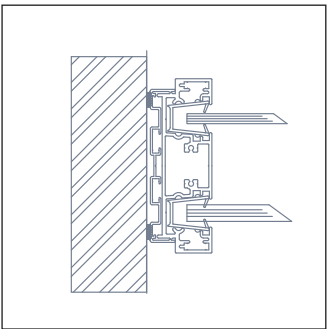

Glazed abutment

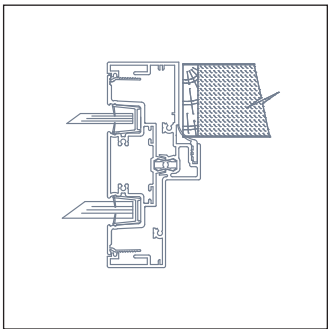

Glazed to doorset junction

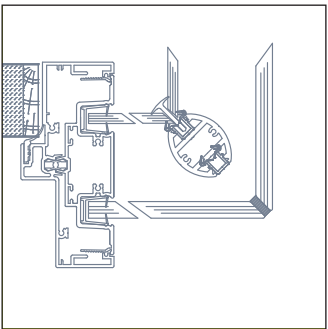

90° glazed to doorset junction





Single glazing  
within pre-cast  
glass pockets  
and abutments

# Confluence™

confident





Pre cast solid plaster section  
incorporating glazing

Confluence™

Confluence provides a seamless monolithic interface between glass and drywall partitions through pre-cast patented solid plaster components

Technical spec at a glance	
	DIMENSIONS: Up to 3000mm high
	FIRE RATINGS: Up to 30/30
	ACOUSTICS: Up to 46dB (Rw)
	STRUCTURE: Contact our technical department
	DEFLECTION HEAD (+/-): N/A
	WEIGHT Per m <sup>2</sup> (kg): Contact our technical department
	BLINDS: N/A
	MANIFESTATION: N/A

Detailed Confluence drawings can be found on pages 70-71. In addition a partitioning product comparison chart can be found on the inside back cover of this brochure.

For further technical specifications and technical drawing downloads go to - [www.komfort.com](http://www.komfort.com)



Pre formed abutments with single glazed sections



Confluence creates a flowing transition from glass to solid. Its unique construction creates the precise angles that discerning designers strive for but never find in any other proprietary partitioning system.

Confluence™



Polar glazing into pre cast plaster glass pocket



Pre cast plaster sections



Solid pre cast plaster sections to encase the glass





Confluence - double glazed partitioning system

- |                                   |                             |
|-----------------------------------|-----------------------------|
| 01 Head channel                   | 07 Base channel             |
| 02 Head channel seal              | 08 Base channel leg         |
| 03 PVCu glazing channel           | 09 Glazing bead             |
| 04 Plaster glazing mullion        | 10 Glass packer             |
| 05 Plaster skirting               | 11 Plaster abutment channel |
| 06 10/12mm toughened safety glass |                             |

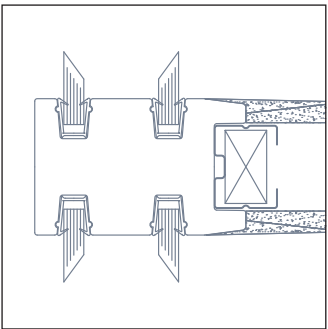

3 way solid to double glazed

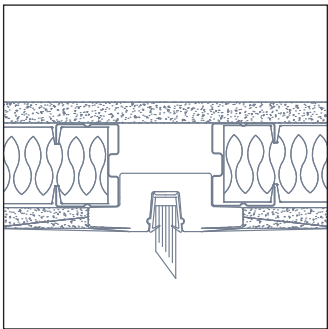

3 way solid to glazed to solid junction

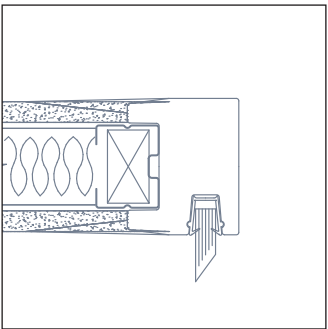

90° solid to glazed junction

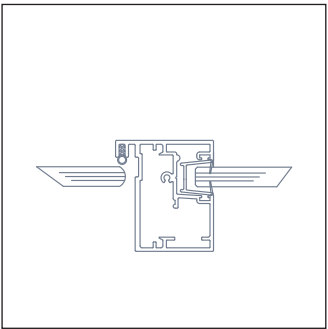

Glazed to aluminium door frame with glass door



90° glazed junction

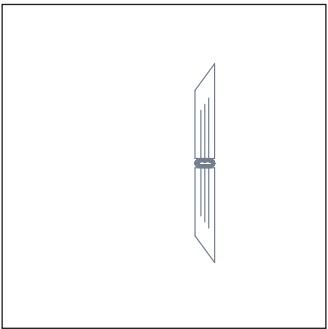

Glazed to glazed junction

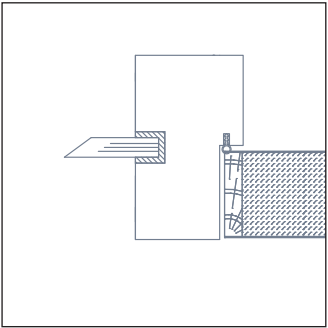

Glazed to timber door frame with timber door

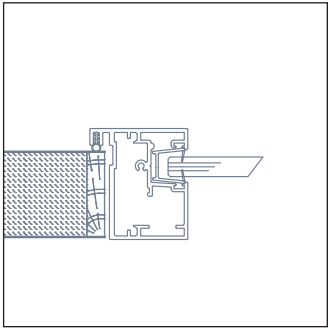

Glazed to aluminium door frame with timber door

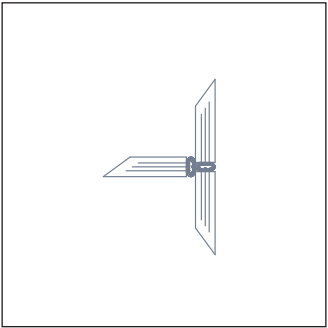

3 way glazed junction

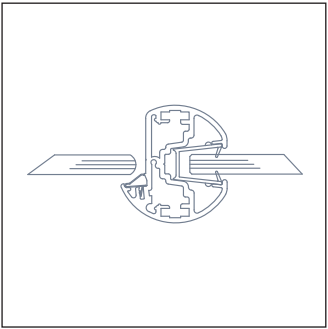

Glazed to halo aluminium door frame with glass door

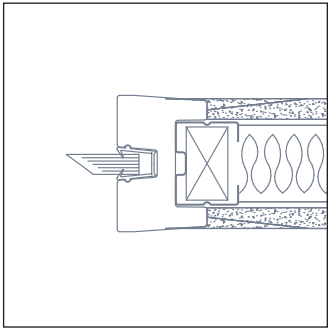

Glazing pocket from 75mm plasterboard partition system

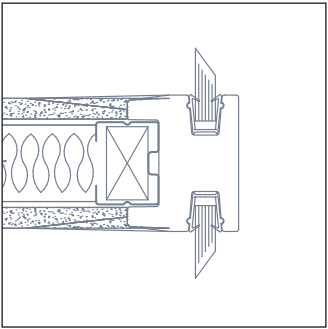

3 way glazed to solid to glazed junction

These drawings are for guidance only. For comprehensive information please contact our technical department



Single glazed Polar  
incorporating veneered  
and fabric Workwall

# POLAR Single Glazed featuring Workwall

effective



POLAR  
Single Glazed  
featuring Workwall

Polar single glazed with display  
and storage Workwall unit





Single glazed Polar with Workwall creating  
dividing walls and modular offices

POLAR  
Single Glazed  
featuring Workwall





Workwall unit to  
house AV system

Workwall adds a vertical dimension to Polar, crafting functional and imaginative work havens. Floating in a sea of glass, these stations provide areas for concentration yet maintain the visual communication demanded from the Polar range.

## POLAR Single Glazed featuring Workwall



Single glazed Polar with  
Workwall encompassing  
storage and desk units



Workwall and single glazed  
Polar create individual office  
spaces



Full height single glazed Polar  
with veneered Workwall  
modules





Curved single glazed Polar  
meeting pod with curved  
Manet sliding door and  
pull handles

## Glass Doors

Komfort's considerable choice of glass and timber doors form an integral part of any partition wall. Choose from pivot, sliding, framed or frameless to enhance the overall design.

portal





Single glazed door within SJ35 doorframe with patch hinges, patch lock and lever handle



Standard height single glazed pivot doors with patch hinges and stainless steel D handles

Glass Doors



Full height single glazed pivot doors with patch hinges and stainless steel D handles



Double single glazed pivot doors with patch hinges and stainless steel pull handles



## Glass Doors



Double Manet sliding  
glass doors



Full height Trojan double  
sliding doors



Glass Doors



FD30 fire rated  
glass doorset



Flush double glazed door



Glass Doors



Delicate film graphics applied  
to single glazed Polar

## Blinds & Graphics

Re-enforce corporate and brand identities, add drama by replicating town or country scenes or simply comply with the building regulations using minimalist patterns. The imaginative use of blinds and graphics can bring vibrancy to any project and give it a wholly unique appearance and style.

embellish





Double glazed Polar with  
integral Venetian blinds  
and control knobs



Single glazed Polar with applied  
coloured graphics to replicate  
the beauty of a dandelion

Blinds &  
Graphics







Double glazed Polar incorporating SwitchGlass EC film in OFF state. The film can be projected on when OFF and provide privacy at the flick of a switch.



SwitchGlass EC film in ON state

SwitchGlass





Komfort's  
Kompendium

Whether for commercial, creative, administrative or industrial workplaces Komfort's range of partition products create the perfect solution.

For a copy of Komfort's Kompendium brochure contact your local sales office or download it from **[komfort.com](http://komfort.com)**

Uniclass	EPIC
L384:D32	C441
CI/SfB	
32	(22.3) X



# The Kompendium

Love the space you're in.



Full height single offset glazed Klassic partitioning incorporating banded manifestation and veneered doors



Banded landscape glazed Ls90 partitioning



Komfort's  
Kompendium



# POLAR Partitioning - system guide & performance options

	Construction Type				Trim Finish		Glass to Glass Joint		Door Finish				Fire Performance BS 476 : Part 22				Sound Performance dB (Rw) BS EN ISO 140-3				System Construction										
	Full Height glazed	Dado Height glazed	Aluminium Deflection Head	Steel deflection Head	Satin Anodised	Kolourframe powder coated in any BS4800 or RAL colour	Bubble Dry Joint	Two Part Dry Joint	Silicon Joint	Ghost Post Joint	Glass non performance 12mm thick toughened	Glass with overpanel fire performance 12mm thick Pyran	Timber Veneer pre-finished with UV lacquer	Timber Laminated or PVCu	Glass Sliding	Certificated Glass Doorset Assembly	Certificated Timber Doorset Assembly	Glazed Screen (Insulation and Integrity)	Glass Door in Aluminium Door Frame	Timber Door in Aluminium Door Frame	Timber Door in Timber Door Frame	Single Glazed	Double Glazed	Glass Door in Aluminium Door Frame	Timber Door in Aluminium Door Frame	Sliding Glass Door with threshold seals	Strength & Robustness 12mm glass BS 5234 duty level	Crowd Pressure (Line Load) 12mm glass	Nominal Thickness	Nominal Width	Maximum Height (subject to design layout and glass type)
Polar Single Glazed	■		■	■	■	■	■	■	■		■	■	■	■	■	■	■	30/30	FD30	FD30	FD30	33 to 38 <sup>a</sup>	NA	31	33	25	Severe <sup>a</sup>	1.5kN/m	25mm <sup>c</sup>	1.2m	3.2m
Polar Double Glazed	■		■	■	■	■	■			■	■	■	■	■	■	■	■	None	None	None	None	NA	41 to 49 <sup>b</sup>	31	33	25	Severe <sup>a</sup>	1.5kN/m	80mm <sup>d</sup>	1.2m	3.3m
Polar Vision Double Glazed	■		■	■	■	■	■	■			■	■	■	■		■	■	30/30	FD30	FD30	FD30	NA	43 to 48 <sup>b</sup>	32	33	NA	Heavy	1.5kN/m	80mm <sup>d</sup>	1.2m	3.0m
PolarTec Double Glazed	■			■	■	■		■	*	■	■	■	■	■		■	■	30/30	FD30	FD30	FD30	NA	46 to 47 <sup>b</sup>	31	33	NA	Severe	1.5kN/m	80mm <sup>d</sup>	1.2m	3.0m
Polar 100 Single Glazed	■				■	■	■	■	■		■		■	■				None	None	None	NA	30 to 36 <sup>a</sup>	NA	24	30	NA	Severe	1.5kN/m	100mm	1.2m	3.0m
Polar 100 Double Glazed	■				■	■	■	■		■	■		■	■				None	None	None	NA	NA	40 to 45 <sup>b</sup>	24	30	NA	Severe	1.5kN/m	100mm	1.2m	3.0m
Confluence Single Glazed	■				■	■	■	■	*		■		■	■				None	None	None	None	33	NA	31	33	NA	Not Tested	Not Tested	75mm	1.2m	3.0m
Confluence Double Glazed	■				■	■	■	■		■	■		■	■				None	None	None	None	NA	44	32	33	NA	Not Tested	Not Tested	100mm	1.2m	3.0m

<sup>a</sup> - Subject to glass type      <sup>c</sup> - Two part base channel  
<sup>b</sup> - Glass combination      <sup>d</sup> - Three part base channel



# **AVANTA**

## WORKSPACE CREATION

Tel: 0800 975 4933 / 0113 384 8777

Fax: 0113 384 8778

Email: [sales@avantauk.com](mailto:sales@avantauk.com)

Web: [www.avantauk.com](http://www.avantauk.com)

Avanta UK Ltd • Unit B1 • Astra Park • Parkside Lane • Leeds • West Yorkshire • LS11 5SZ

